

# SI SERIES INSIDE CORNERS

## SAMPLE SPECIFICATION

specify as: SOFTFORMS® Model # SI-X-XXX

### Pitcon SOFTFORMS® LLC

6409 Rhode Island Avenue 3330 W. Flower Street  
 Riverdale, MD 20737 Phoenix, AZ 85017  
 (800) 637-7638 (800) 637-7638  
 (301) 927-1000 (602) 233-9100  
 Fax: (301) 699-8690 Fax: (602) 233-9400

The extruded aluminum profile shall incorporate a continuous integral fin for surface contact to conventionally installed gypsum drywall. The fins shall be 7/8" wide and shall be tapered to the edge. The tapered fins shall be punched with holes staggered to accept standard screw fastening. A series of continuous grooves shall be extruded into the face of the fins to provide greater bonding surface. The extruded profiles shall be primed with corrosion-resistant primer compatible with materials normally in use in conjunction with commercial interiors, i.e.: joint compound, latex and enamel paints, and wall covering adhesives.

MATERIAL: Aluminum alloy.....6063 T5 or equal  
 Finish.....Factory primed

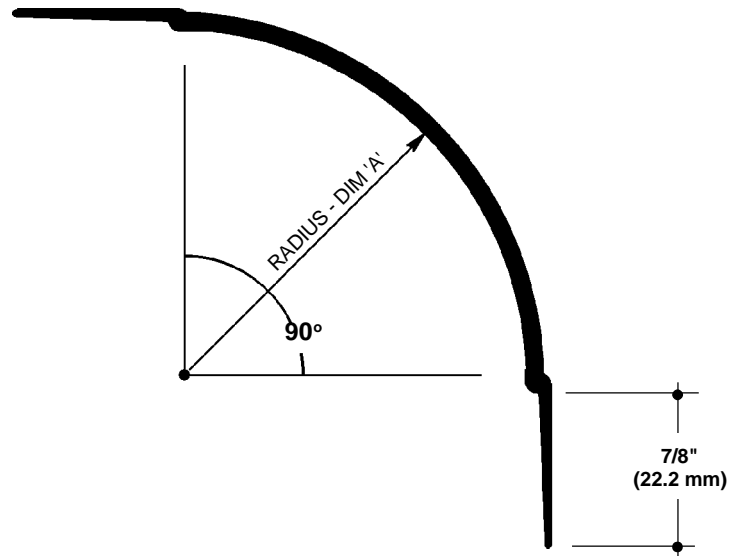

SI SERIES  
NO SCALE

INSIDE CORNER  
TYPICAL SECTION

## SELECTING YOUR SOFTFORMS® SI SERIES OF ALUMINUM EXTRUSIONS

Select proper SOFTFORMS extrusion from the ordering information shown below.

Model Number	Radius
SI-9-075	3/4" (19.1 mm)
SI-9-100	1" (25.4 mm)
SI-9-150	1-1/2" (38.1 mm)
SI-9-200	2" (50.8 mm)
SI-9-300	3" (76.2 mm)
SI-9-400	4" (101.6 mm)

Note:  
 Special custom sizes are also available. Check with factory for availability and lead time.

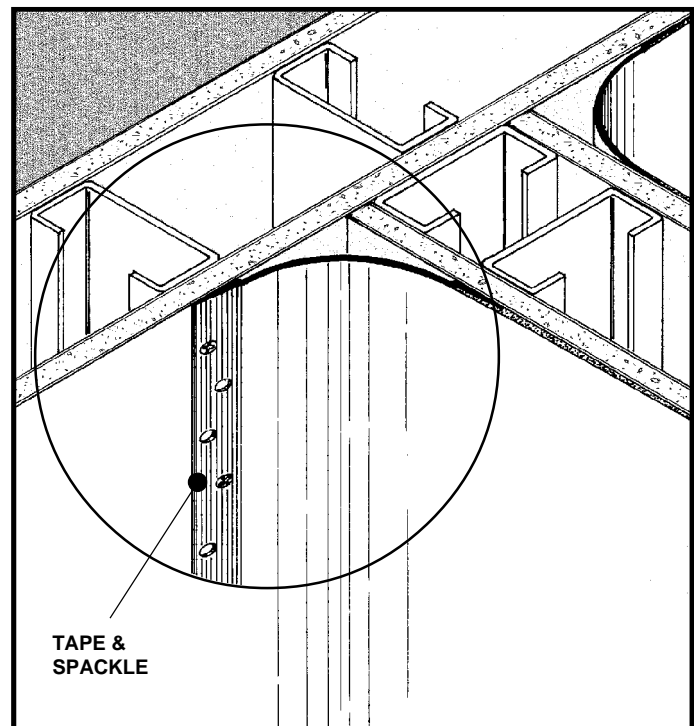

All details, methods and specifications are the exclusive property of Pitcon Softforms® LLC. Pitcon reserves the right to change any specifications or details without prior notification. All Softforms® profiles are available in standard 10' lengths ±1/8" (2.048 M). Other lengths are available as special order items. For custom shapes, sizes, or for special finishes, please contact the factory or your nearest Pitcon sales representative.

# SI SERIES INSIDE CORNERS

## SELECTING YOUR SOFTFORMS® SI SERIES OF ALUMINUM EXTRUSIONS

Select proper SOFTFORMS® extrusion from the ordering information shown below.

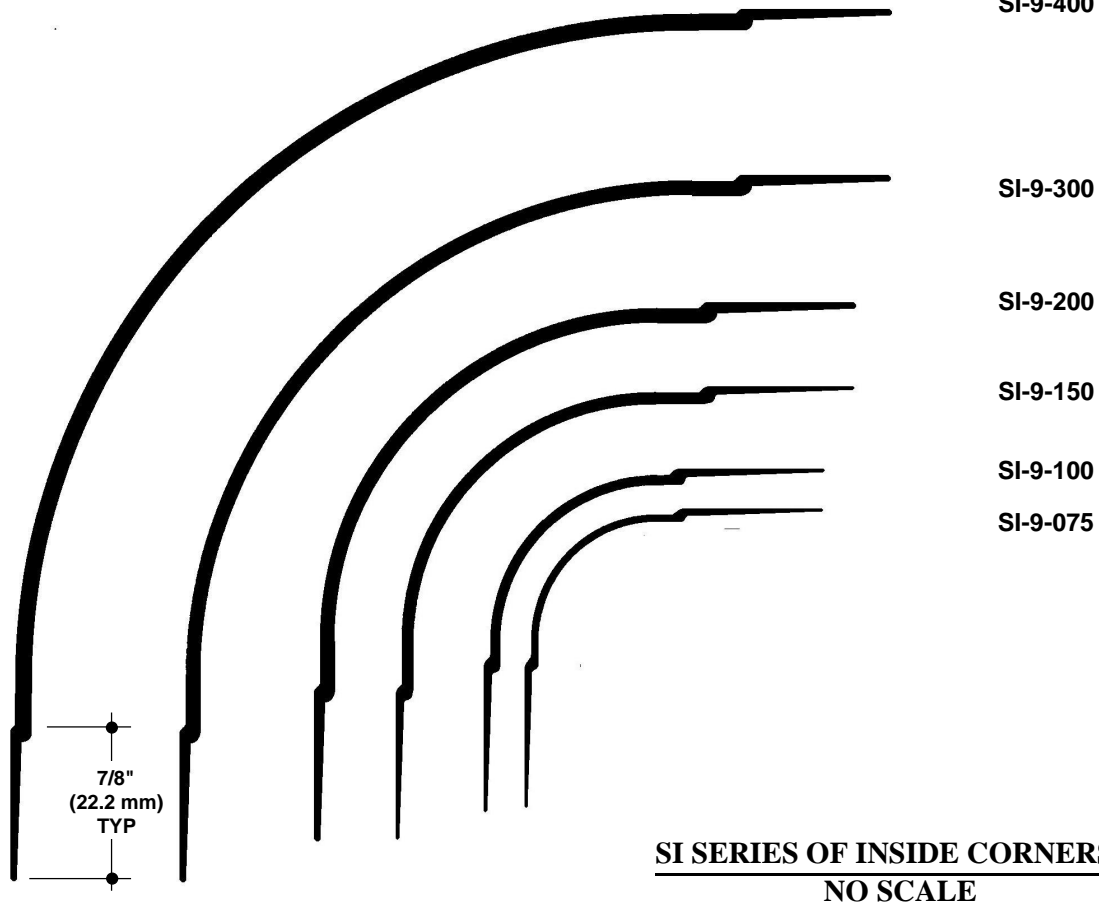

### EXAMPLE DETAIL

For use with conventional metal stud construction and 1/2" or 5/8" GPDW.

The drawing below depicts the appropriate size, number, and placement of metal studs needed to accommodate the SI-9-200 inside corner and the corresponding SO-9-200 outside corner. The use of identical radii is recommended for both inside and outside corners when they appear in view of one another. Optional ceiling trims for acoustical tile support are available in either a pre-finished white or primed for field finishing. Screws through the grooved fins must always engage metal or wood substructure to ensure proper installation.

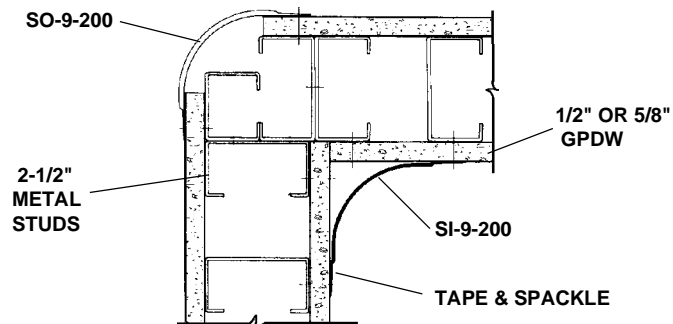

**SI-9-200 + 2-1/2" STUD WALL**

**NO SCALE**

**TYPICAL**

### Pittcon SOFTFORMS® LLC

6409 Rhode Island Avenue  
Riverdale, MD 20737  
(800) 637-7638  
(301) 927-1000  
Fax: (301) 699-8690

3330 W. Flower Street  
Phoenix, AZ 85017  
(800) 637-7638  
(602) 233-9100  
Fax: (602) 233-9400

# Softforms®

PREFORMED ARCHITECTURAL PROFILES  
FOR DRYWALL CONSTRUCTION