

SWS-9-100

STEP - 1" RADIUS

SAMPLE SPECIFICATION

specify as: SOFTFORMS® Model # SWS-9-100
Specify as: Pittcon Drywall Molding

Model No.

MATERIAL: Aluminum alloy.....6063 T5 or equal
Finish.....Factory primed

The extruded aluminum profile shall incorporate a continuous integral fin for surface contact to conventionally installed gypsum drywall. The fins shall be 7/8" wide and shall be tapered to the edge. The tapered fins shall be punched with holes staggered to accept standard screw fastening. A series of continuous grooves shall be extruded into the face of the fins to provide greater bonding surface. The extruded profiles shall be primed with corrosion-resistant primer compatible with materials normally in use in conjunction with commercial interiors, i.e.: joint compound, latex and enamel paints, and wall covering adhesives.

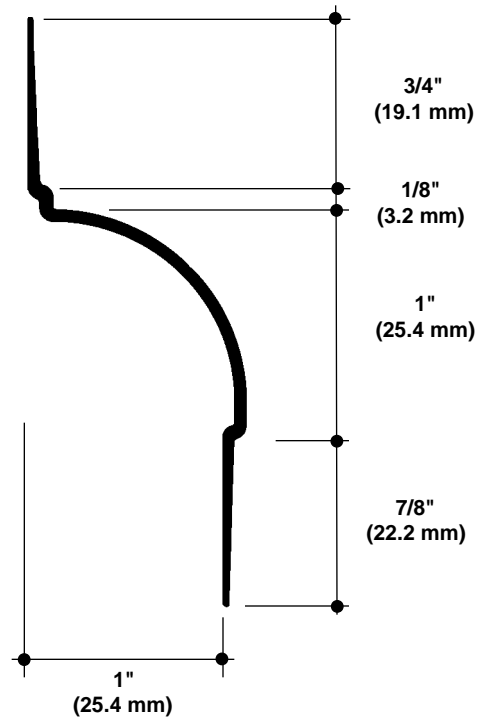

SWS-9-100
NO SCALE

CEILING STEP 1" RADIUS
FOR 2 SHEETS 1/2" GPDW

EXAMPLE DETAIL

For use with conventional metal stud construction and 1/2" or 5/8" GPDW.

The SWS-9-100 can be used to create a softly radiused transition in ceiling or wall surface, allowing recessed or raised areas. Multiple steps can be added using stacked layers of 1/2" GPDW as shown below. When used in conjunction with square edged steps, such as the SWS(033-050) unique and striking features can be designed. Screws through grooved fins must always engage metal or wood substructure to ensure proper installation.

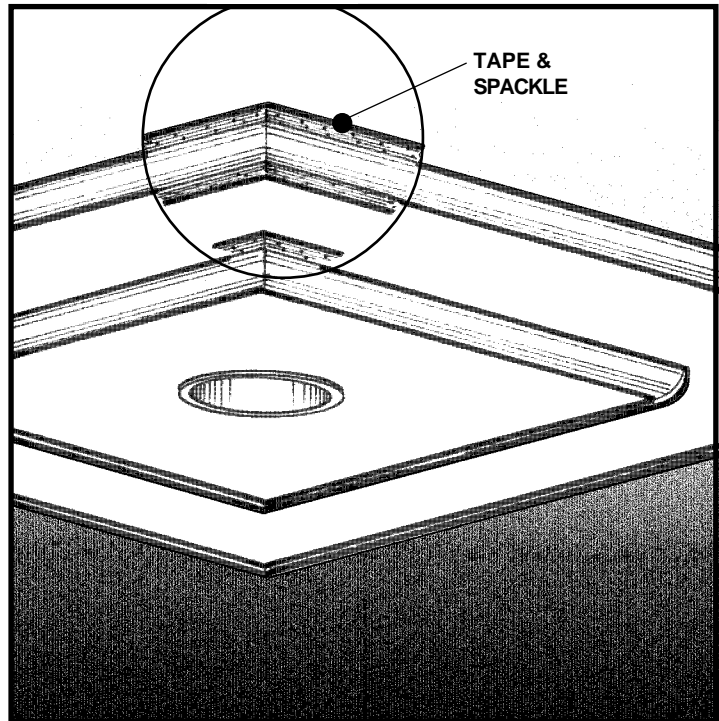
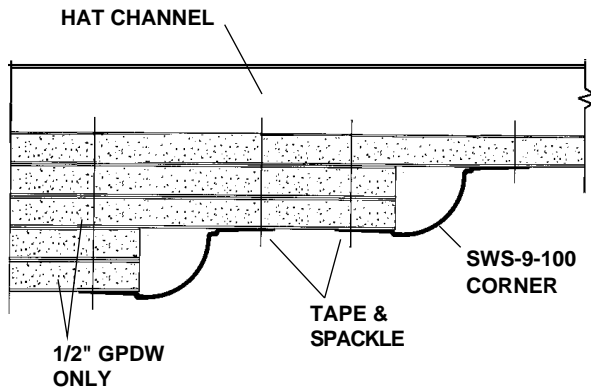

SWS-9-100 **SINGLE STEP**
NO SCALE **SECTION**

© 2008 Pittcon Industries



2090 Del Rio Way, Unit B
Ontario, CA 91761
Phone: (909) 773-0001
Fax: (909) 773-0091

3330 W. Flower Street
Phoenix, AZ 85017
Phone: (602) 233-9100
Fax: (602) 233-9400

Pittcon
Industries
DIVISION OF PITTCOON ARCHITECTURAL METALS, LLC
800 637-7638



6409 Rhode Island Ave.
Riverdale, MD 20737
Phone: (301) 927-1000
Fax: (301) 699-8690